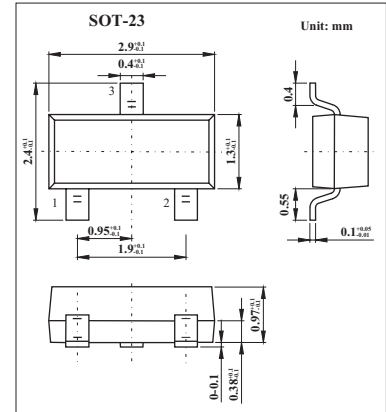

## Silicon Schottky Barrier Diode

## HRW0502A

## ■ Features

- Low forward voltage drop and suitable for high efficiency rectifying.
- MPAK package is suitable for high density surface mounting and high speed assembly.

■ Absolute Maximum Ratings  $T_a = 25^\circ\text{C}$ 

Parameter	Symbol	Value	Unit
Repetitive peak reverse voltage	$V_{RRM}$	20	V
Average rectified current	$I_o$	500	mA
Non-repetitive peak forward surge current	$I_{FSM}$ (Note 1)	5	A
Junction temperature	$T_j$	125	$^\circ\text{C}$
Storage temperature	$T_{stg}$	-55 to + 125	$^\circ\text{C}$

Note

1. 10msec sine wave 1 pulse

■ Electrical Characteristics  $T_a = 25^\circ\text{C}$ 

Parameter	Symbol	Conditions	Min	Typ	Max	Unit
Forward voltage	$V_F$	$I_F = 500\text{ mA}$			0.40	V
Reverse current	$I_R$	$V_R = 20\text{ V}$			200	$\mu\text{ A}$
Capacitance	C	$V_R = 0\text{ V}, f = 1\text{ MHz}$		120		pF
Thermal resistance	$R_{th(j-a)}$	Polyimide board		340		$^\circ\text{C/W}$

## ■ Marking

Marking	S10
---------	-----